

◆ WWC ◆

*Western Window Coverings, Inc.*



Triple Shades 2023

# Avant Triple Shade™

Avant Triple Shade™ features carefully selected fabric options paired with the innovative features of the CSA-153™ cassette system provides stability and style with ease of installation.

- Cassette & Bottom Rail with Matching Fabric Insert.
- Clutch/continuous cord operated shades are equipped with cord tension devices to prevent loops or loose cords from forming.
- Motorized operation utilizes industry leading motors that are known for their quiet operation and ease of use.

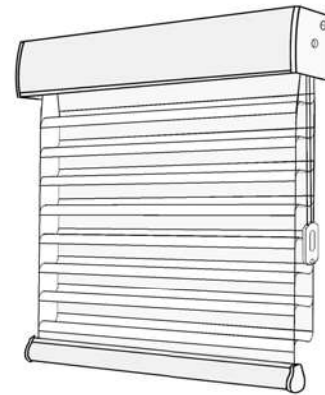

Continuous Cord/Clutch  
Operation



Motorized Operation

# Product Component Overview

## Avant Triple Shade™ System

- 1. Cassette
- 2. Bottom rail
- 3. Cassette End Cap (Right)
- 4. Cassette End Cap (Left)
- 5. Bottom Rail End Cap (Right)
- 6. Bottom Rail End Cap (Left)
- 7. Bottom Rod
- 8. Tube (38mm)
- 9. Inner Bracket (L)
- 10. Clutch (38mm)
- 11. Idle End Plug
- 12. Continuous Cord
- 13. Cord Tension Device
- 14. Cord Tension Device Mounting Bracket
- 15. Mounting Bracket
- 16. Clip
- 17. Level Controller Cap
- 18. Remote

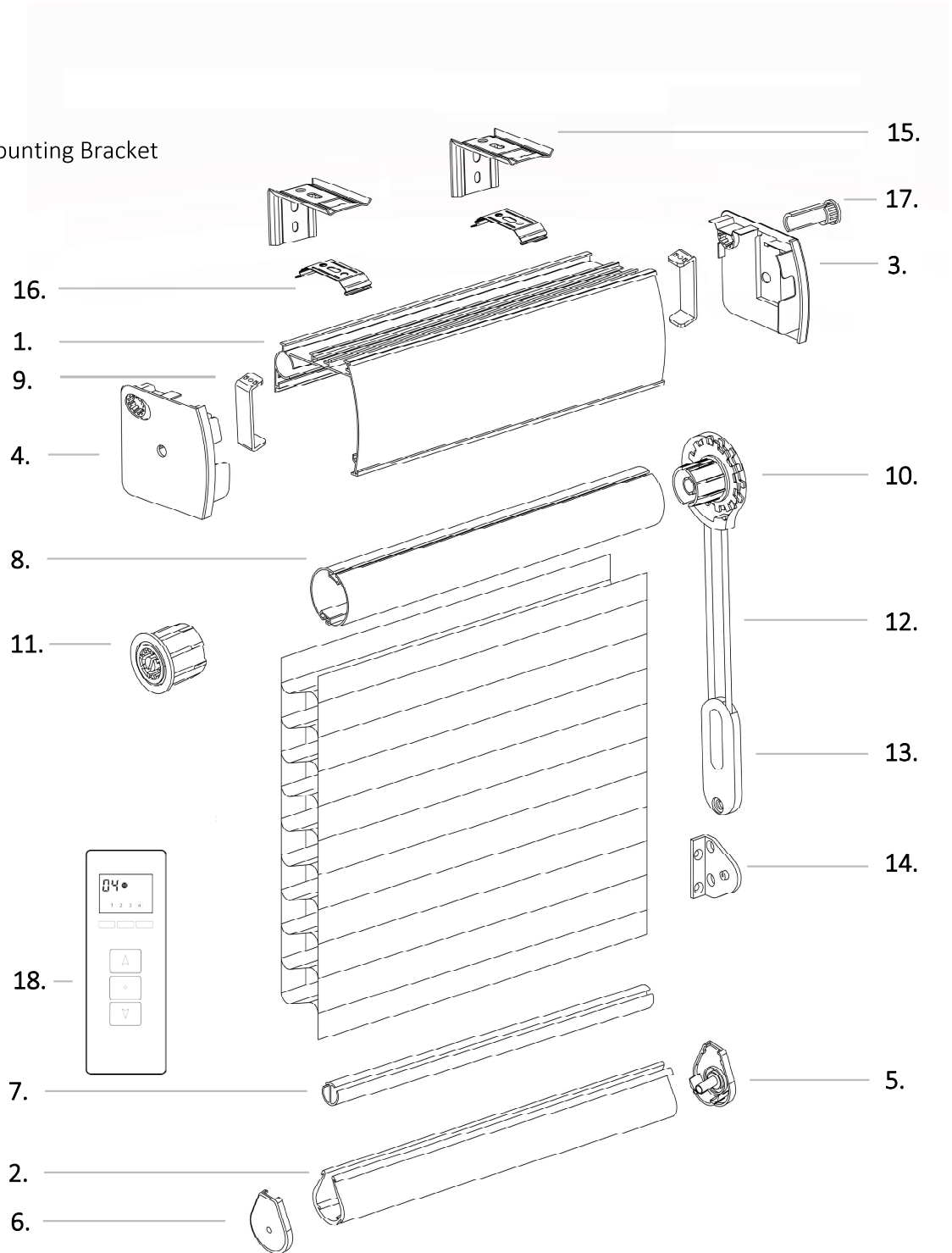

## Minimum Size

Clutch operated with continuous cord .....	8" x 16"
Rechargeable Battery Motor.....	22 1/2" x 16"
Hardwired DC Motor .....	15 5/8" x 16"

\*Please refer to Color Table and Fabric Technical Data pg. TR-06 for further information regarding *maximum shade size*.

## Standard Cord Length

Shade Height	Cord Length
18"-27 7/8" .....	18"
28"-39 7/8" .....	24"
40"-59 7/8" .....	36"
60"-83 7/8" .....	48"
84"-107 7/8" .....	60"
108" and over .....	72"

\*If any cord or metal chain measures 97" to 140", a surcharge of \$8.00 will be applied.

\*\*All continuous cords will be matched to the appropriate component color. Please refer to Color Table and Fabric Technical Data page (see page TR-06).

## Side by Side Alignment

- Allowable tolerance for fabric pattern alignment of side-by-side shades is up to 1/4".
- Only applicable for shades ordered at the same time with identical height, fabric style, and
- color. Please specify desired line numbers under the side-by-side column on the order form.

## Tube Size

Shade Size	Internal Dimension	Outside Dimension
Up to 78"	36mm	38mm
78 1/8" & above	38mm	40mm

## Component Color Option



## Finished Dimensions

	Inside Mount (IM)	Outside Mount (OM)	End Mount (EM)
Cassette unit	-1/8"	-0"	-5/8"
Shade height	-1/8"	-0"	-1/8"
Fabric width	-1 1/16"	-1 1/16"	-1 9/16"

## Mounting Requirements

Inside Mount	
Minimum Casement Depth.....	2"
Fully Recessed .....	3 5/8"
Outside Mount	
Minimum Mounting Surface Height.....	1 3/4"
End Mount	
Minimum Casement Depth .....	2"

## Bracket Requirements

Shade Size	# of Brackets
Up to 40" .....	2
40 1/8" - 70" .....	3
70 1/8" - 96" .....	4

## Light Gaps

Light gap is measured from the edge of the window opening to the edge of fabric.

Inside Mount	
Clutch Side .....	1/2"
End Plug Side.....	5/8"

## Fabric Note

- The overlapping portions of sheer on the fabric may cause a slight moiré effect.
- Due to the inherent characteristics of textiles, waviness and wrinkles may be present and should be considered normal. Please note that these characteristics may be more pronounced on wider shades.

## Child Safety Tension Device

In accordance with the revised American National Standard (ANSI WCMA A100.1- 2018) for Safety of Corded Window Covering Products, Combi Shade® requires proper mounting of the tension device on cords that exceed 40% of the shades height for the product to function safely and properly. Tension devices should not be modified in any way.

## Tile Cut

Upon request, the bottom bar assembly and fabric can be cut down to a specified size, different from the width of the cassette assembly.

### Measuring and ordering "Tile Cut".

#### Step1

Measure the uppermost position "A" of the window opening to determine the window opening size.

#### Step 2

Measure the inside width of the window opening at the lowermost position "B" to determine the bottom window opening size

#### Step2

Please specify the determined width of the lowermost position under "tile cut" column.

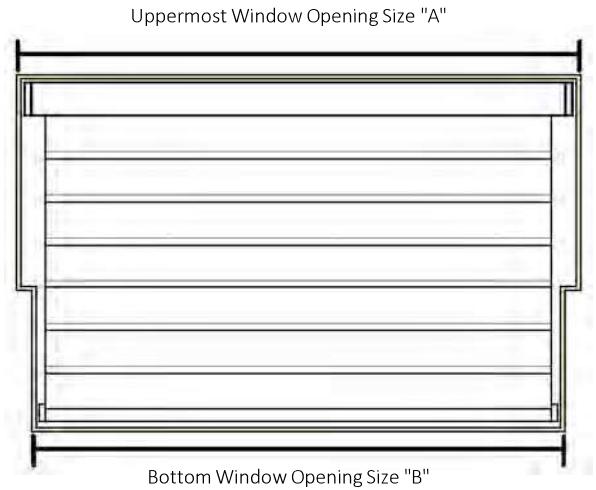

## Measuring Corner Windows

There are a few different approaches to measuring for corner windows. Please consider the formed light gap in relation to viewing angle from both inside and outside and how this might affect privacy.

### Options 1 & 2

#### Step1

Measure the inside width of both window openings at the uppermost position to determine the widths of the cassette.

#### Step2

Decide which of the two shades will be full or butt shade.

#### Step3

Deduct 3 3/8" from the determined width of the butt shade.

#### Option 1

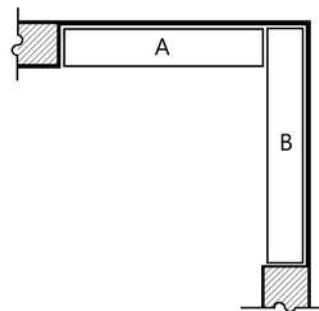

#### Option 2

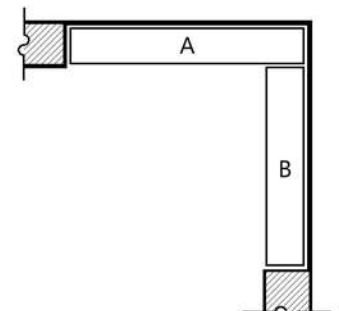

### Option 3

#### Step1

Measure the inside width of both window openings at the uppermost position to determine the widths of the cassette.

#### Step2

Once both measurements are acquired, deduct 3 3/8" from both shades.

#### Option 3

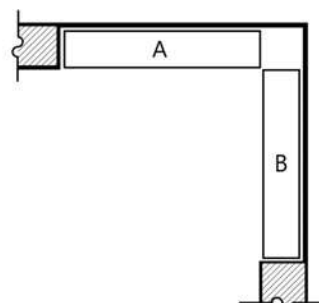

#### Important!

This option will greatly increase the amount of light gap formed along the corner.





Price Group C		Albany80 Milan				Natural Swan Swan						
		36	42	48	54	60	66	72	78	84	90	96
HEIGHT UP TO:	42	251	293	334	376	417	459	501	542	584	627	670
	48	286	334	382	430	478	525	573	621	670	718	763
	54	322	376	430	484	537	590	645	698	753	806	859
	60	358	417	478	537	597	657	718	776	836	896	954
	66	393	459	525	590	657	722	788	854	919	985	1050
	72	430	501	573	645	718	788	859	932	1002	1075	1147
	78	465	542	621	698	776	854	932	1009	1087	1165	1242
	84	501	584	670	753	836	919	1002	1087	1171	1255	1338
	90	537	627	718	806	896	985	1075	1165	1255	1344	1433
	96	573	670	763	859	954	1050	1147	1242	1338	1433	1529
	102	608	711	811	913	1015	1117	1218	1320	1421	1522	1625
	108	645	753	859	967	1075	1182	1290	1398	1504	1612	1720
114	680	794	907	1021	1134	1248	1362	1474	1589	1702	1816	
120	718	836	954	1075	1190	1314	1433	1552	1672	1791	1911	

Note: Product price only, does not include freight, state/local taxes, measuring and installation, and other services associated with custom installation.

## Avant Triple Shade™ Color Table

Product Name	Color	Color Name	Component Color
ALBANY 80 DECK# T-01 8028030	AL-01	White	White
	AL-02	Ivory	Ivory
	AL-03	Beige	Ivory
	AL-04	Grey	Grey
	AL-05	Black	Black
MILAN DECK# T-03 7526030	MI-01	White	White
	MI-02	Ivory	Ivory
	MI-03	Beige	Ivory
	MI-04	Grey	Grey
	MI-05	Dark Grey	Grey
NATURAL SWAN DECK# T-04 7527540	NS-01	White	White
	NS-02	Beige	Ivory
	NS-03	Hazel Wood	Brown
	NS-04	Brown	Brown
	NS-05	Oak	Brown
	NS-06	Grey	Grey
	NS-07	Dark Grey	Grey
SWAN DECK# T-07 7527540	SW-01	White	White
	SW-02	Cream	Ivory
	SW-03	Silver Grey	Ivory
	SW-04	Shark	Grey
	SW-05	Beige	Ivory
	SW-06	Latte	Brown
	SW-07	Acorn	Brown
	SW-08	Coffee	Brown
	SW-09	Black	Black

## Fabric Technical Data

Color Deck #	Pattern Name	Fabric Info	Composition (%)	Maximum Width (in)	Maximum Length (in)	Maximum sqft.	Weight: (g/m2)	Thick-ness	Packing	Fire Retardant	Qty of Colors
T-01	ALBANY 80	8028030	100% Polyester	76"	98"	51 sqft	185.1 g/m2 (±5%)	0.015" (±5%)	110" x 32.8yd /Roll	Non F/R	5
T-03	MILAN	7526030	100% Polyester	76"	98"	51 sqft	145 g/m2 (±5%)	0.017" (±5%)	102" x 32.8yd /Roll	Non F/R	5
T-04	NATURAL SWAN	7527540	100% Polyester	76"	98"	51 sqft	167 g/m2 (±5%)	0.026" (±5%)	108" x 43.7yd /Roll	Non F/R	7
T-07	SWAN	7527540	100% Polyester	76"	98"	51 sqft	167 g/m2 (±5%)	0.026" (±5%)	108" x 43.7yd /Roll	Non F/R	5



Western Window Coverings, Inc.

Avant Collection Motorized Pricing):

Motor – Built-in Rechargeable Battery (Minimum Width 22 ½”) \$440.00

12V Motor – External Rechargeable Battery Pack (Minimum width 15 5/8”) \$600.00

Charger \$70.00

10 ft Extension Cable \$50.00

1-Channel Remote \$90.00

5-Channel Remote \$110.00

8-Channel Remote \$160.00

16-Channel Remote \$200.00

1-Channel Wall Switch \$100.00

2-Channel Wall Switch \$120.00

8-Channel Wall Switch \$170.00

Alpha Neo Link Hub \$500.00

Note: This applies to Combi Shade, Avant Roller Shade and Triple Shades.



# Avant Motorized Controllers

Combi Shade® motorized shade systems offer consumers the option of integrating their motorized shades with a compatible smart home application through the use of Neo Link Box. This small and innovative device modernizes the way consumers can operate their shades, by providing access from a smart device. Simply download the free Neo app thru Google play or Apple App store. Once set up, consumer will have the ability to control one or various shades through their smart devices remotely. In addition, the Neo link box may be integrated for voice command through Amazon Alexa, Control4, Google Home, and Savant.

## Handheld Remote Options

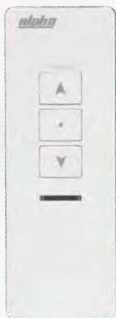

1 Channel Handheld Remote RE301



5 Channel Handheld Remote RE302

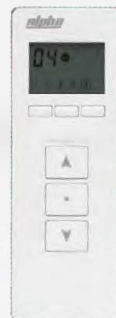

8 Channel Handheld Remote RE303-8c



CR2032

All remotes and controllers utilize CR2032.

## Wall Mount Controller Options



1 Channel Wall Mount Control RE201



2 Channel Wall Mount Control RE202



8 Channel Wall Mount Control RE203-8c

## Hub/Wifi Controller



Avant Wifi Hub

